

*Main Level*

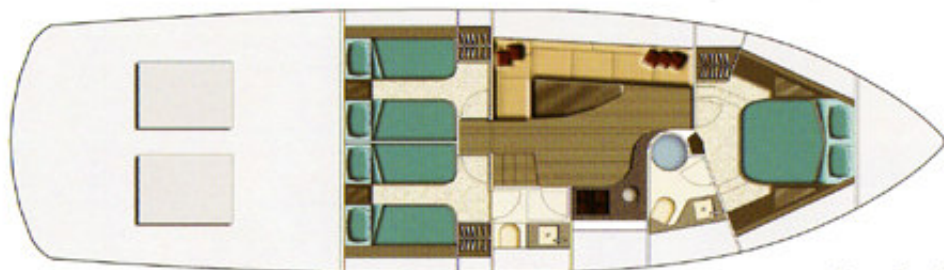

*Lower Level*



*Profile*

**TECHNICAL DATA**

Length overall (LOA)	16.6 m	(54.40 ft)
Beam (Max.)	4.70 m	(15.42 ft)
Draft at full load (from propeller tip)	1.51 m	(4.95 ft)
Dead rise	16.8 degrees	
Full load displacement	25.7 t.	
Fuel capacity	2,500 lt.	(660.4 gal.)
Fresh water capacity	500 lt.	(132 gal)
Power	2 x MAN 1,100 HP at 2300 rpm	
* Cruising speed	31 +/- 5% knots	
* Maximum speed	35 +/- 5% knots	
Cabins	3	
Berths	6	
Building Material	GRP	
Yacht Design	De Birs Yachts / Arrabito	
Naval Architecture	De Birs Yachts / Arrabito	
Engineering	De Birs Yachts / Arrabito	
Interior Design	De Birs Yachts	

\* The aforesaid data are subject to modifications during project development.  
 \* Speed is an estimate as it may vary with the selection of main engines and optional equipment added on board.